

TKC TKC Connection SMS 3008

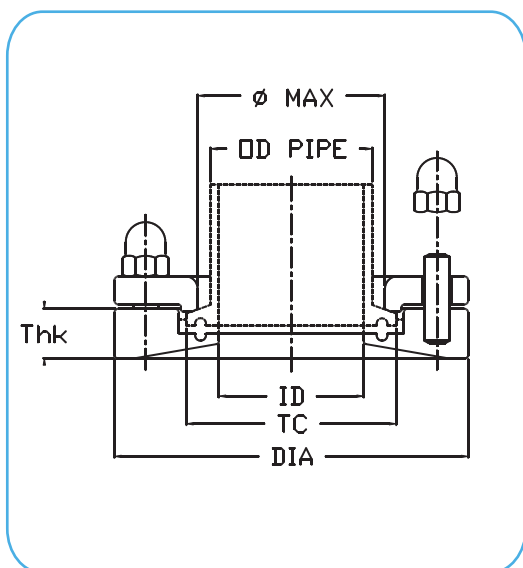

CODE	Size	ØTC	ID	OD pipe	Ømax	DIA	Thk std (mm) #	Thk (mm) #	Thk (mm) #	Thk (mm) #	Bolts
TKC-JE0#-12A	12	25	10	12	20	55	15	25	38	51	4 x M6
TKC-JG0#-12A	18	25	15	18	20	55	15	25	38	51	4 x M6
TKC-JJ0#-12A	25	50.5	22.6	25	45	85	17	25	38	51	4 x M8
TKC-JM0#-12A	38	50.5	35.6	38	45	85	17	25	38	51	4 x M8
TKC-JN0#-12A	51	64	48.6	51	57	100	17	25	38	51	4 x M8
TKC-JO0#-12A	64	77.5	60.3	63.5	71	112	17	25	38	51	4 x M8
TKC-JP0#-12A	76	91	72.9	76.1	85	130	20	25	38	51	6 x M8
TKC-JR0#-12A	102	119	97.6	101.6	113	170	20	25	38	51	8 x M8

Technical Information:

Tri-Clamp Connections: according to SMS 3008

Welding Flange Material: AISI 316L – 1.4404 | *on request 1.4435 or other special steels* |

Locking Ring Material: AISI 316L – 1.4404

Bolts and Nuts Material: AISI 304 – 1.4301

Internal Surface Finish: $R_a \leq 0.5 \mu m$ → code **12** e.g.: TKC-JE015-**12A**

Optional: For customized TKC-J Connections, please contact us.

Specifications:

Regulatory: designed according to PED 2014/68/EU directive, ASME VIII Div.2 and F.E.M. (Finite Element Method) calculated, approved and certified by notified body.

Design Pressure: 7 barg (101,5 psig)

Design Temperature: -80°C to 200°C [-112°F to 392°F]

Note: The applied gasket (not included) may have different design temperature and/or pressure limits than the TKC. The weakest component in the assembled product determines the maximum design temperature and pressure limits.

Marking: Each TKC Connection is marked with Heat No. for full lot traceability.

CONFIGURATOR



DATASHEETS



Last updates can be found on our website - www.aerreinox.it
In the interests of development of the product, we reserve the right to change the specifications without prior notice